

KYDEX® SHEATH INSTRUCTIONS

Your White River™ Knife comes complete with a custom molded KYDEX® Sheath. This sheath can be assembled in multiple different configurations for the right or left hand. The sheath can also be used as a neck knife by omitting the use of the belt loop and tying a lanyard to the bottom two holes of the sheath. The method for assembly can be seen in the illustration below:

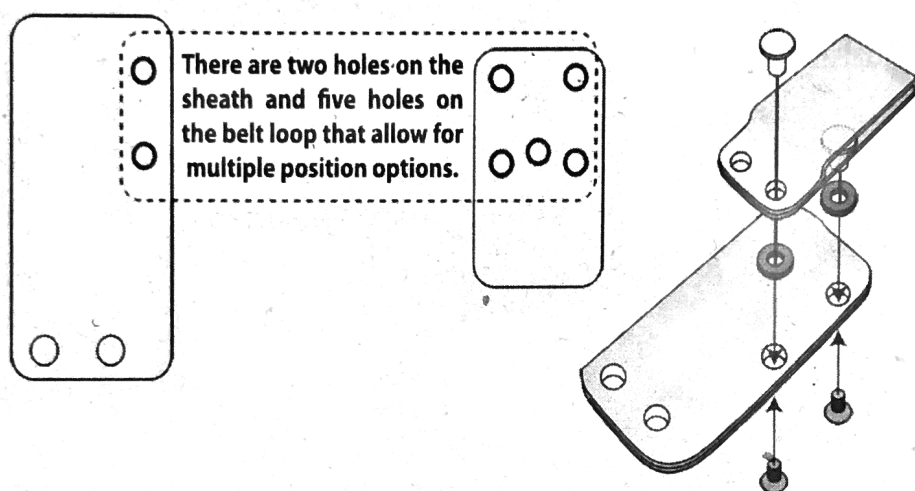

- 1: Determine the belt loop holes to be used according to the configuration examples below.
- 2: Insert the posts into the appropriate belt loop holes as shown in the illustration.
- 3: Insert the posts through the rubber washers and the two holes on the side of the sheath.
- 4: Tighten the screws into the posts with an Allen wrench. Use of a medium strength thread locking compound is recommended.

